



HOW TO MOUNT THE ALPRIDE AIRBAG SYSTEM 2.0

ELEVATE YOUR SAFETY



HOW TO MOUNT THE ALPRIDE AIRBAG SYSTEM 2.0

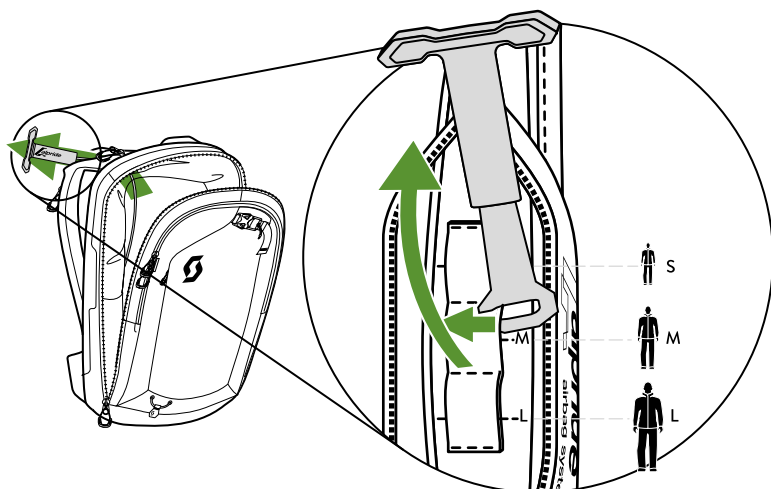

1

OPEN THE BACKPACK. INSERT THE TRIGGER IN THE SHOULDER STRAP, TURN UP THE HANDLE TO CHANGE THE HEIGHT POSITION AND CLIP IT ON THE SHOULDER STRAP WEBBING.

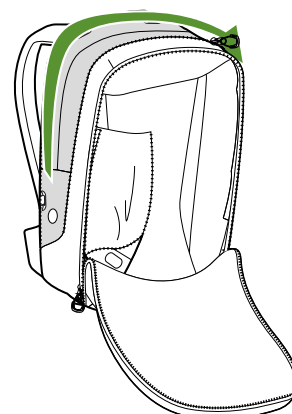

2

FULLY OPEN THE AIRBAG COMPARTMENT ZIPPER.

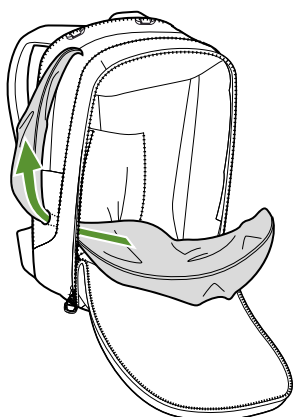

3

PUT THE AIRBAG THROUGH THE HOLE.

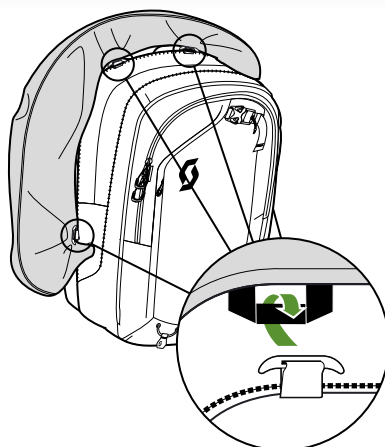

4

INSERT ALL FOUR HOOKS.

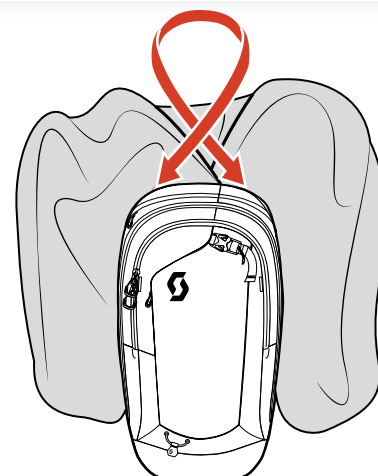

×

DO NOT TWIST THE AIRBAG!

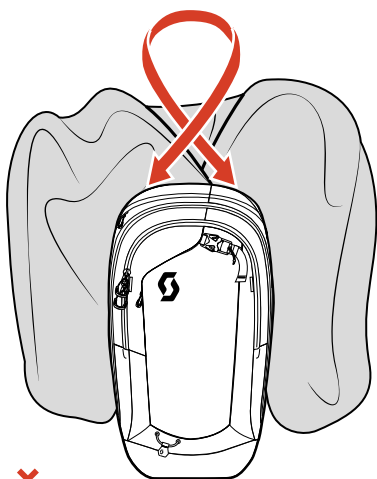

×

DO NOT CROSS THE HOOKS!

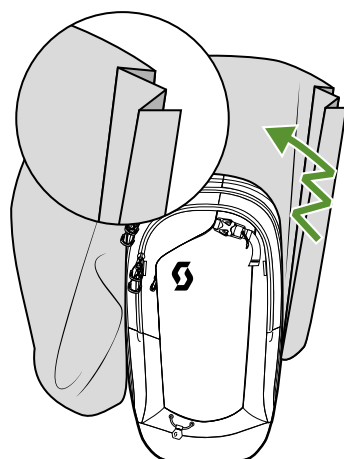

5

TURN THE BACKPACK BACK ROUND AND FOLD IN THE RIGHT SIDE OF THE AIRBAG AS SHOWN ABOVE.

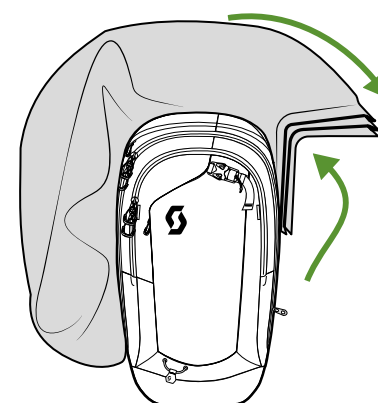

6

PUSH THE AIRBAG TOWARDS THE LEFT AND PUSH THE UPPER PART TOWARDS THE RIGHT. LEFT HAS TO OVERLAY THE RIGHT PART.

HOW TO MOUNT THE ALPRIDE AIRBAG SYSTEM 2.0

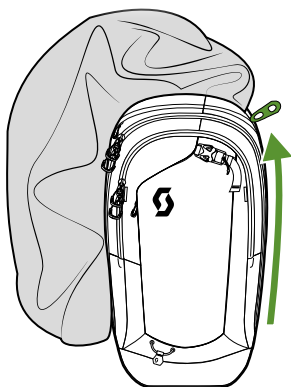

7

CLOSE THE FIRST PART OF THE AIRBAG COMPARTMENT.

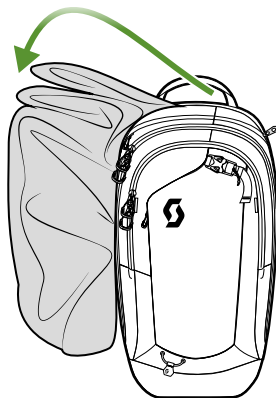

8

PUSH THE TOP ON THE LEFT SIDE.

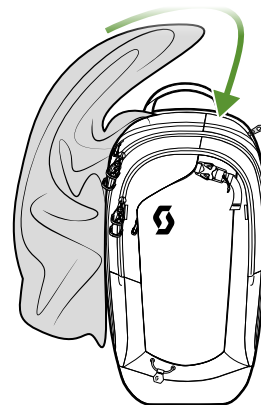

9

PUSH THE TOP ON THE LEFT AND PUSH THE UPPER PART TOWARDS THE RIGHT SIDE OF THE BACKPACK.

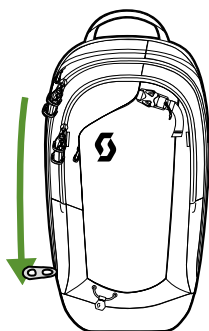

10

PUSH THE LAST PART OF THE AIRBAG INTO THE COMPARTMENT AND CLOSE THE ZIPPER COMPLETELY.

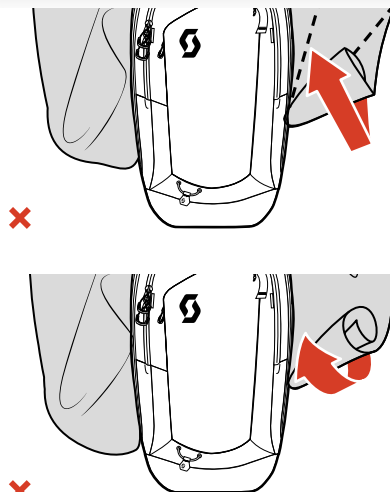

×

×

DO NOT FOLD OR ROLL THE AIRBAG!



11

CLOSE THE VELCRO.

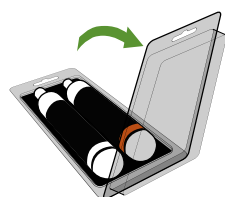

12

OPEN THE PACKAGING BOX AND TAKE OUT THE CARTRIDGES.

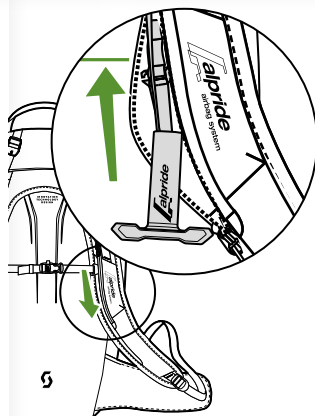

13

PUT THE HANDLE ON THE UPPER POSITION.

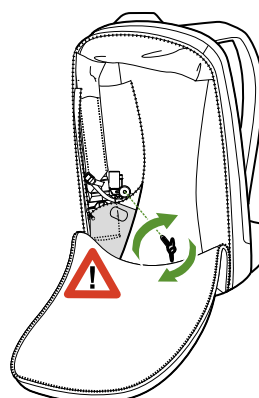

14

TURN THE SCREW TO LOAD THE INFLATOR SYSTEM AND UNSCREW TO REMOVE TOOL.

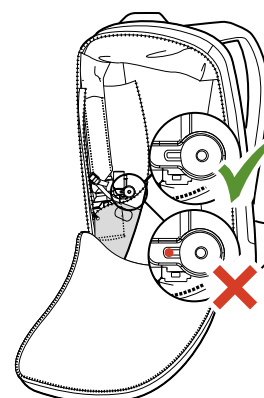

15

THE SYSTEM IS READY TO USE WHEN THE RED PIN IS NO LONGER VISIBLE.

HOW TO MOUNT THE ALPRIDE AIRBAG SYSTEM 2.0

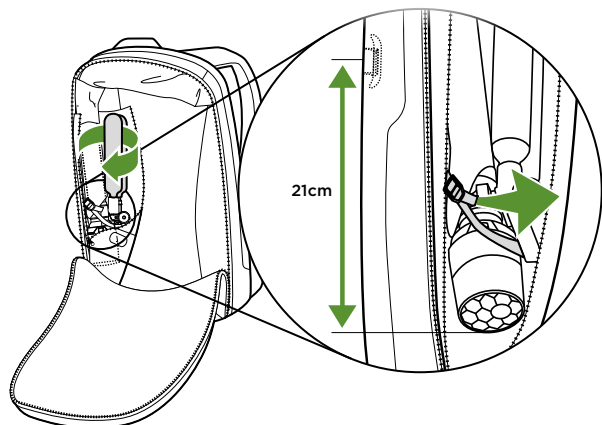

16

SCREW IN THE CARTRIDGE IN A CLOCKWISE DIRECTION.
MAKE SURE YOU ONLY EVER SCREW IN A FULL CARTRIDGE!
MAKE SURE THE STRAP IS ALWAYS WELL TIGHTENED.

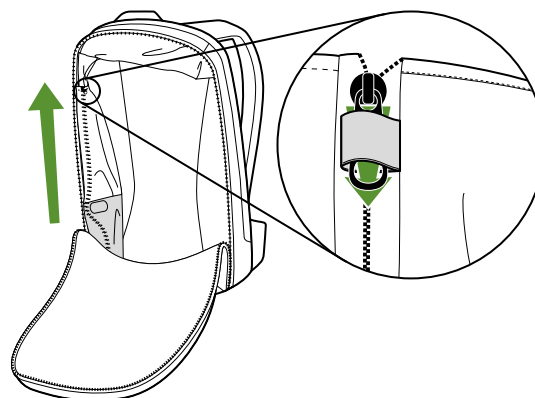

17

CLOSE THE INFLATOR COVER WITH THE ZIPPER.

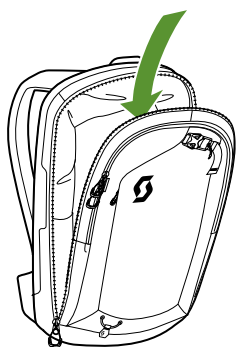

18

PACK YOUR BACKPACK FOR YOUR RIDE.

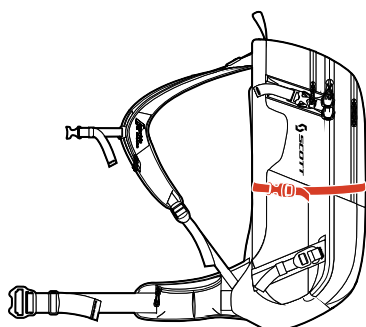

×

DO NOT BLOCK THE AIRBAG!

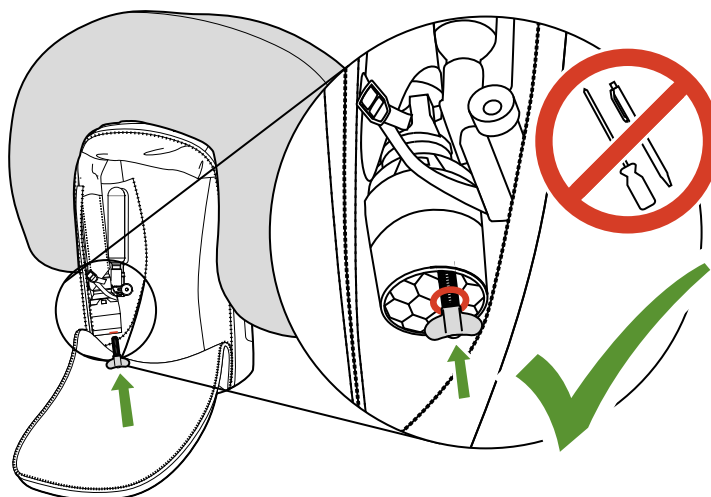

×

TO DEFLATE THE AIRBAG, USE THE SCREW ONLY (NOT A SCREW DRIVER OR A PEN).